

# SHOP-DC Cabinet Shop Desk

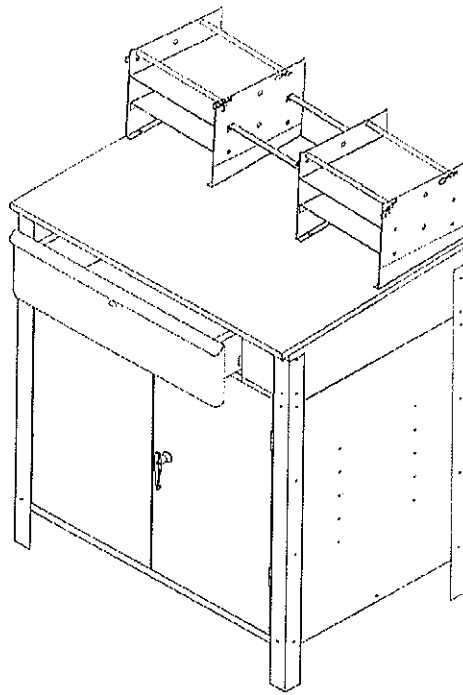

## TOOLS NEEDED

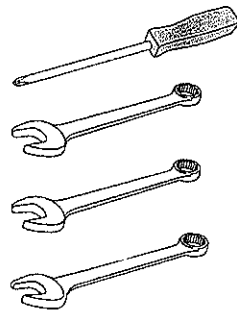

Phillips Screwdriver

10 mm Wrench

8 mm Wrench

7 mm Wrench

## CONTENTS

REF.	QTY.	DESCRIPTION
1	1	RIGHT SIDE TRACK SUPPORT
2	1	LEFT SIDE TRACK SUPPORT
3	2	TRACK
4	1	DESKTOP
5	2	FRONT LEG
6	2	BACK LEG
7	1	FRONT TOP CROSS-PIECE
8	2	SIDE PANELS
9	1	BACK PANEL
10	1	MIDDLE SHELF
11	1	BASE SHELF
12	1	TOP SHELF
13	1	LEFT DOOR
14	1	RIGHT DOOR
15	1	DRAWER
16	1	DOOR LOCK & KEY
17	1	DRAWER LOCK & KEY

## CONTENTS

REF.	QTY.	DESCRIPTION
H1	4	
H2	4	
H3	4	
H4	4	
H5	61	
H6	59	
H7	8	
H8	8	
H9	8	
H10	8	

# ASSEMBLY INSTRUCTIONS

On the drawer, remove track from side.

Install back screw first. Front of drawer screw will now line up.

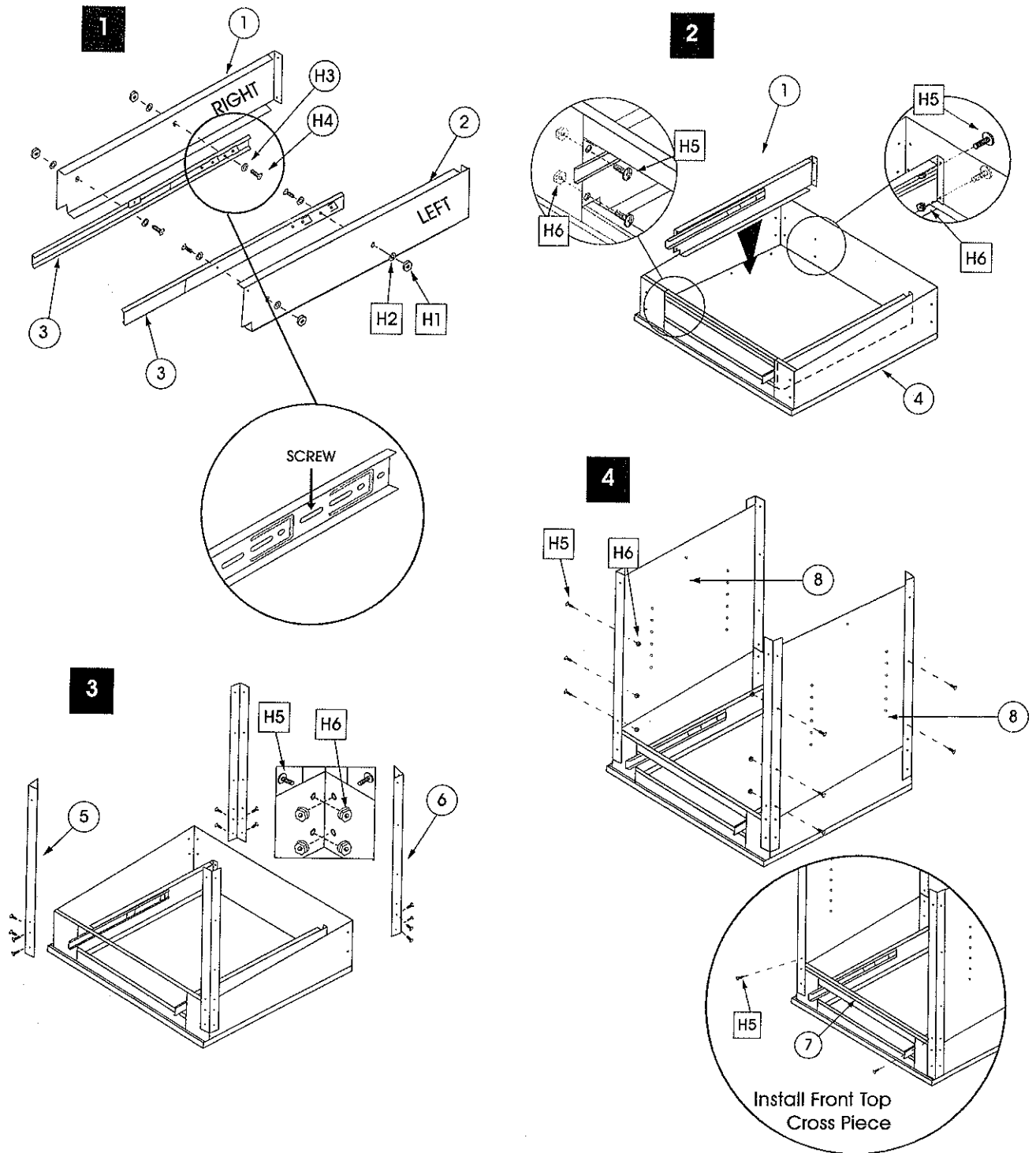

# ASSEMBLY INSTRUCTIONS (CONTINUED)

10

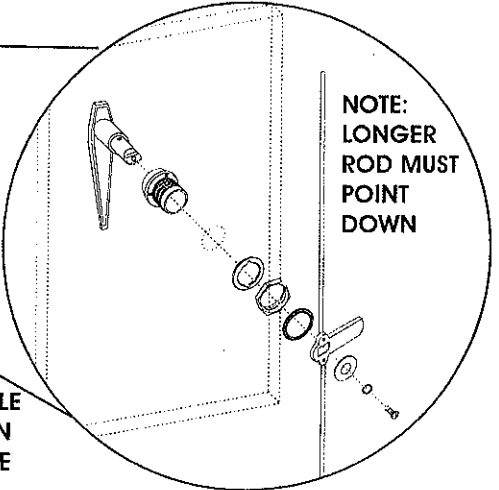
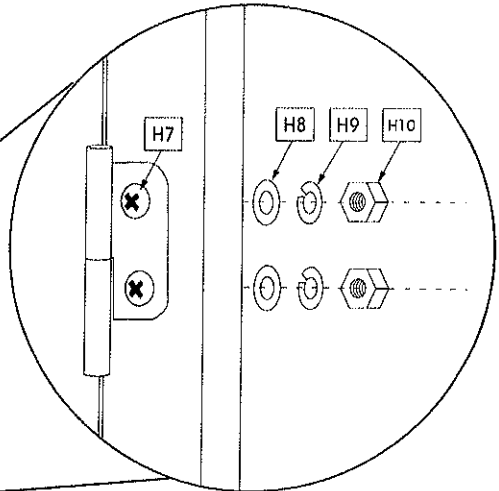
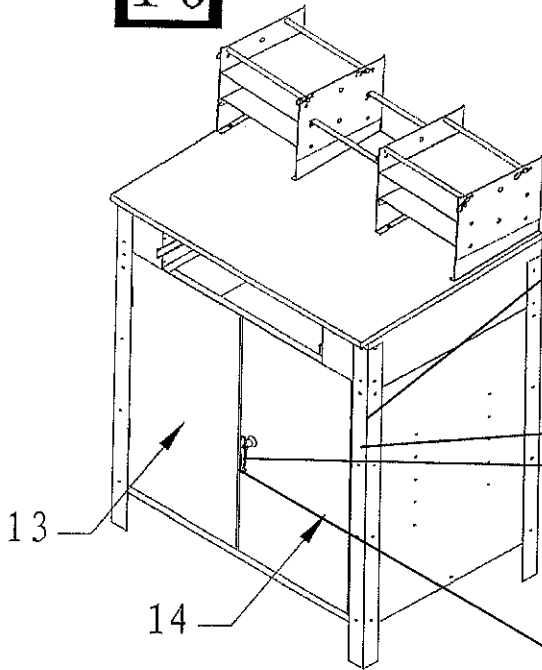

NOTE:  
DISASSEMBLE  
LOCKS THEN  
REASSEMBLE  
AS SHOWN

11

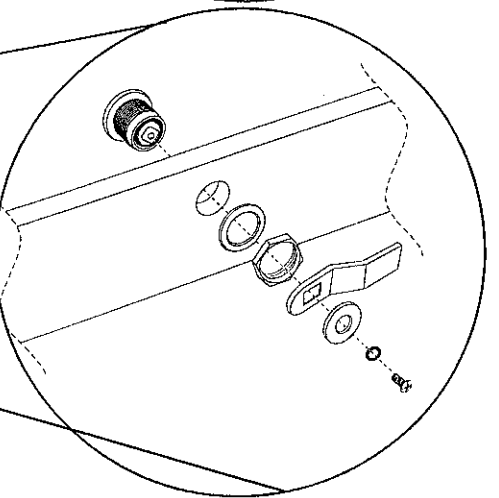
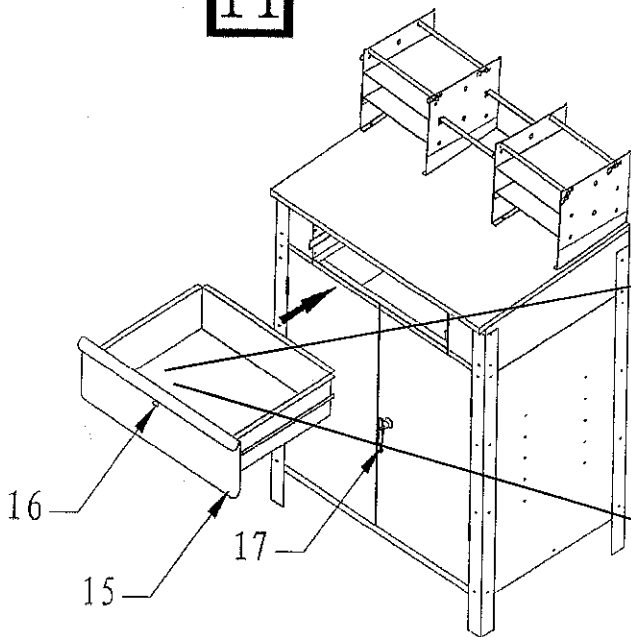

# ASSEMBLY INSTRUCTIONS (CONTINUED)

5

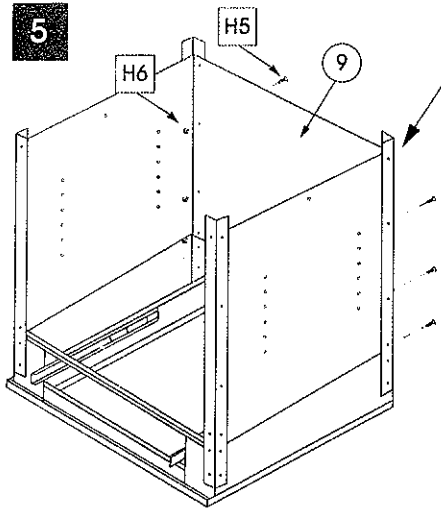

NOTE: WAIT TO INSTALL  
BOTTOMS SCREWS  
UNTIL STEP 7

6

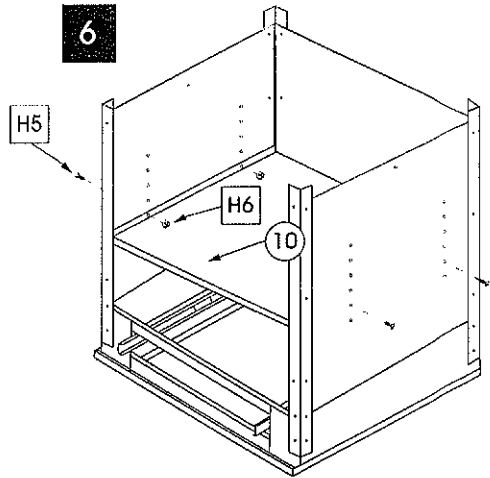

7

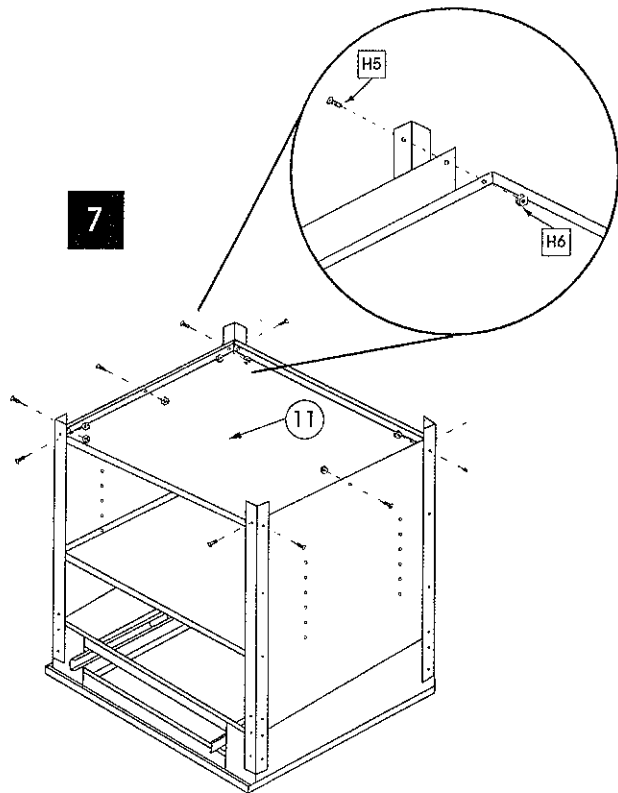

8

